

MNG Ref: 98856st-010d.dgn Date: 4/12/2015

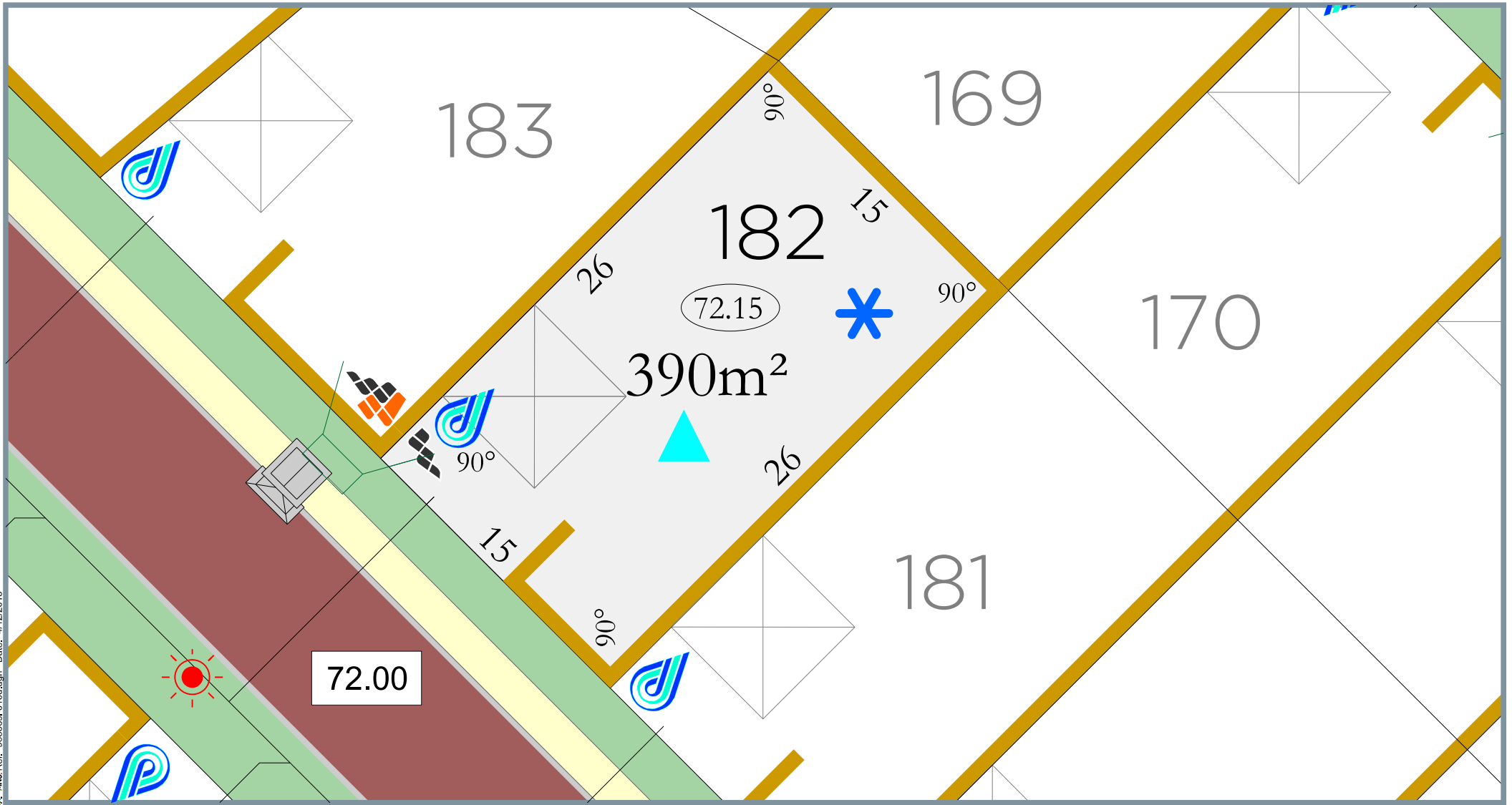

LEGEND:

<p>Drainage Services</p> <ul style="list-style-type: none"> Manhole Side Entry Pit Grate 	<p>Water Services</p> <ul style="list-style-type: none"> Connection Valve Hydrant "D" Deferred 	<p>Footpath</p> <ul style="list-style-type: none"> Footpath 	<p>Brick Paving</p> <ul style="list-style-type: none"> Mocha Cappuccino Red Asphalt 	<p>Lot Levels</p> <ul style="list-style-type: none"> 34.67 35.69
<p>Electrical</p> <ul style="list-style-type: none"> Universal Pillar Powerdome/Connection Mini Pillar Powerdome/Connection Lightpole Padmount site 	<p>Sewer Line</p> <ul style="list-style-type: none"> Manhole Connection 	<p>Retaining Wall</p> <ul style="list-style-type: none"> Retaining Wall Retaining Wall Cantilever Plinth Steel Fence Planter Box 	<p>Two Storey Mandatory</p> <ul style="list-style-type: none"> Two Storey Mandatory Two Storey Preferred 	<p>Road Levels</p> <ul style="list-style-type: none"> Road Levels Crossover Designated Garage Location
<p>NBN Connection, Pit & FDH</p> <ul style="list-style-type: none"> NBN Connection Pit & FDH 	<p>BAL Rating</p> <ul style="list-style-type: none"> 29 19 12.5 	<p>Water Services</p> <ul style="list-style-type: none"> Water Connection 	<p>Brick Paving</p> <ul style="list-style-type: none"> Mocha Cappuccino Red Asphalt 	<p>Lot Levels</p> <ul style="list-style-type: none"> 34.67 35.69

All Dimensions and Areas are subject to survey. The particulars on this brochure are supplied for identification purposes only and shall not be taken as a representation in any aspect on the part of the vendor or its agents. Authorities should be consulted when services are contained within lot boundaries as building restrictions may apply. All retaining walls, services and associated easements are shown exaggerated for legibility.

All Engineering, Electrical, Cadastral & Encumbrances are still to be finalised and are subject to change.



Scale 1:250

Stage 1

Satterley.com.au

Satterley Property Group Pty Ltd
 18 Bowman Street
 South Perth 6151
 ABN 38 009 054 979